





13 801 670

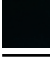

- sporgenza 200 mm
- Getto normale squadrate
- diametro foro 37 mm
- ingresso 1/2"
- portata max 25,1 l/min a una pressione idraulica di 3 bar

	Cromato	13 801 670-00
	Platinato spazzolato	13 801 670-06
	Dark Chrome	13 801 670-19
	Nero opaco	13 801 670-33
	Cromo spazzolato	13 801 670-93

Prodotti complementari



- raccordo angolare ad incasso - 35 085 970 90**
- Profondità d'incasso max. 163 mm
 - profondità d'incasso min. 90 mm

13 801 670

mm [inches]



Diagramma di portata



Certificati

IAPMO_4976 (6). WRAS_2005002.

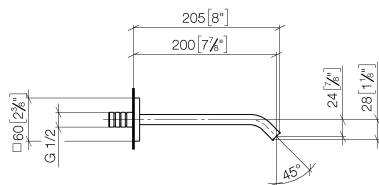
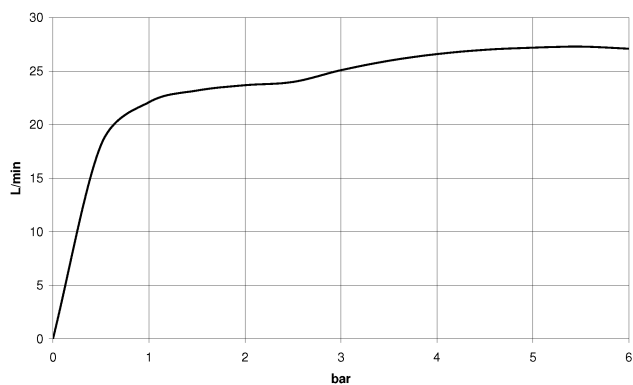
13 801 670

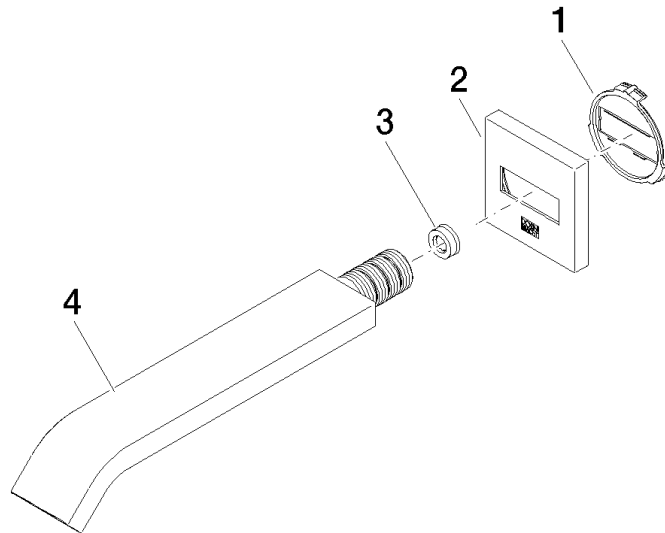

Elenco delle parti di ricambio

N.	Codice articolo	Denominazione	Quantità necessaria	Tempo di produzione
1	09 18 40 139 90	alloggio	1	2
2	09 27 67 008-00	rosetta	1	10
3	09 23 01 057 90	limitatore di portata	1	2
4	04 28 22 241 00-00	bocca di erogazione	1	10